

pop-up playpen assembly instructions

1



remove playpen from storage bag and unwrap the elastic strap from the pen.

2



unfold the playpen.

3



position the 2 separated panels beside each other.

4



locate the zipper pull and join the panels together using the zipper.

5

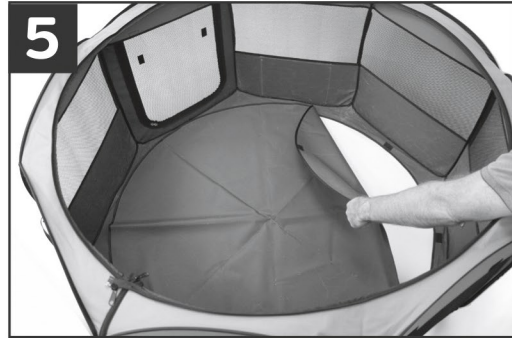

position floor inside playpen and attach to the base by aligning the attached patches.

6

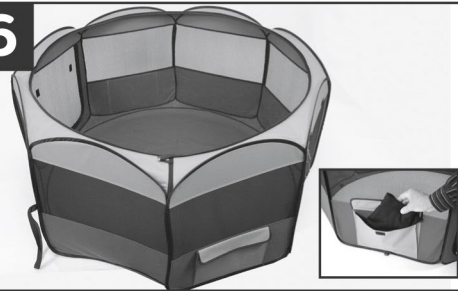

when not in use, screen cover can be folded and placed in the provided storage pocket.

7

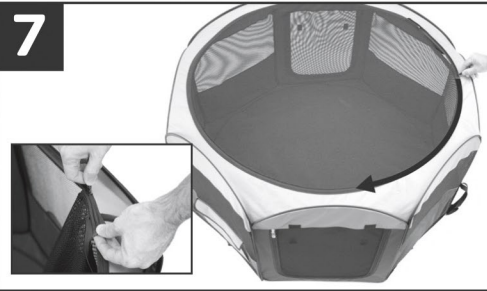

to attach the screen cover find the zipper pull and attach to the playpen roof with zipper.

8

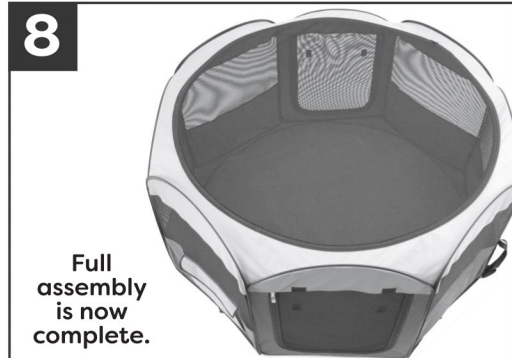

Full assembly is now complete.

fabric care: rinse off with water and dry fully assembled. DO NOT store wet. floor cover can be rinsed and dried flat.

ware cares™

We care about the carbon pawprint we leave as a company and are committed to using recycled and recyclable material in the manufacturing of our packaging and pet products.

care tip:

pets should not be left unsupervised in playpens. the playpen is designed to contain your pet for short periods of supervised exercise and playtime. your playpen is NOT intended as a cage. not suitable for children.

ware®
pet products